

# EUROPLUS

## Dual function pressure balance trim with control module

MODEL # 19881

GROHE America, Inc | 200 North Gary Avenue, Suite G, Roselle, IL 60172  
 Phone: +1 (800) 444-7643 | Fax: +1 (800) 225-2778 | us-customerservice@grohe.com

Pure Freude an Wasser

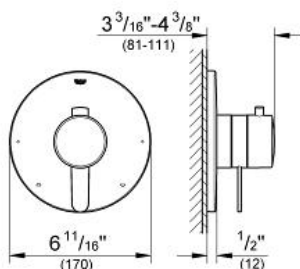

**Product Description:**  
 Dual function pressure balance trim with control module

- Standard Specification:**
- For shower/tubs with non-diverter tub spout or for 2 shower outlet applications
  - Integrated volume control
  - 2-way diverter function
  - 1 axis operation
  - Requires GrohFlex™ universal rough-in box (35 026 000) (sold separately)
  - **GROHE SilkMove®**
  - 5.3 gpm at 45 psi (bottom outlet)
  - 2.9 gpm at 45 psi (top outlet)
  - ABS trim plate
  - **GROHE StarLight®** finish

- Applicable Codes & Standards:**
- Energy Policy Act of 1992
  - ASME A112.18.1/CSA B125.1

- Color:**
- 19881 000 chrome
  - 19881 EN0 brushed nickel

